









28 505 979



- Ausladung 155 mm
- Kugelgelenk 18° schwenkbar (in jede Richtung)
- Dreifach bzw. fünffach verstellbar: PURIFY RAIN, COMPACT SOFT FLOW, COMPACT AQUAPRESSURE FLOW, Durchfluss max. 7,6 l/min (bei 3 Bar)
- mit Antikalk-System
- Brausekopf Ø 100 mm
- Rosette Ø 60 mm
- Anschluss 1/2"
- Funktion ab: 5,5 l/min

Passt zu: TARA, LISSÉ, VAIA, META

|                                                                                     |                                 |               |
|-------------------------------------------------------------------------------------|---------------------------------|---------------|
|    | Light Gold gebürstet            | 28 505 979-27 |
|    | Chrom                           | 28 505 979-00 |
|    | Platin gebürstet                | 28 505 979-06 |
|    | Platin                          | 28 505 979-08 |
|    | Dark Chrome                     | 28 505 979-19 |
|    | Light Gold                      | 28 505 979-26 |
|    | Messing gebürstet (23kt Gold)   | 28 505 979-28 |
|    | Schwarz matt                    | 28 505 979-33 |
|    | Bronze gebürstet                | 28 505 979-42 |
|   | Champagne gebürstet (22kt Gold) | 28 505 979-46 |
|  | Champagne (22kt Gold)           | 28 505 979-47 |
|  | Chrom gebürstet                 | 28 505 979-93 |
|  | Dark Platinum gebürstet         | 28 505 979-99 |

Empfohlenes Zubehör

**UP-Wandwinkel -** 35 085 970 90



- Min. Einbautiefe 90 mm
- Max. Einbautiefe 163 mm

28 505 979

mm [inches]

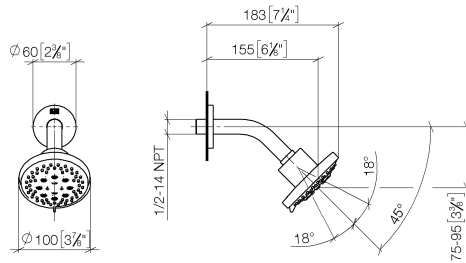

**Durchflussdiagramm**



**Zertifikate**

LGA\_28661.

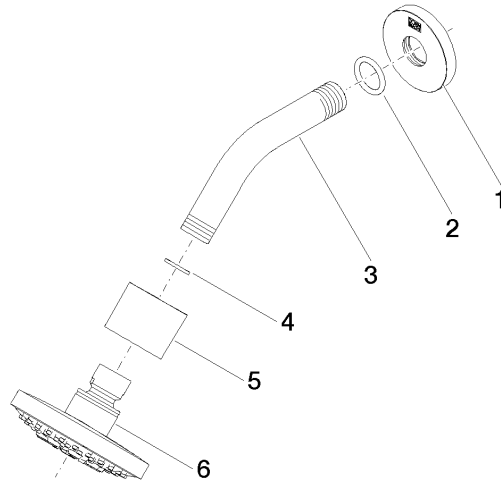

### Ersatzteilstückliste

| Nr. | Artikelnummer      | Benennung | Verbaumenge | Lieferzeit |
|-----|--------------------|-----------|-------------|------------|
| 1   | 09 27 22 045-27    | Rosette   | 1           | 60         |
| 2   | 90 14 10 026 00 90 | Dichtung  | 1           | 2          |
| 3   | 09 11 03 011-27    | Anschluss | 1           | 60         |
| 4   | 90 14 20 002 00 90 | Dichtung  | 1           | 2          |
| 5   | 09 11 01 191-27    | Abdeckung | 1           | 60         |
| 6   | 90 12 05 055 00-27 | Brause    | 1           | 30         |